

PLAN COFRAJ CAMIN TIP 14

SECTIUNEA 1-1

SCARA 1:50

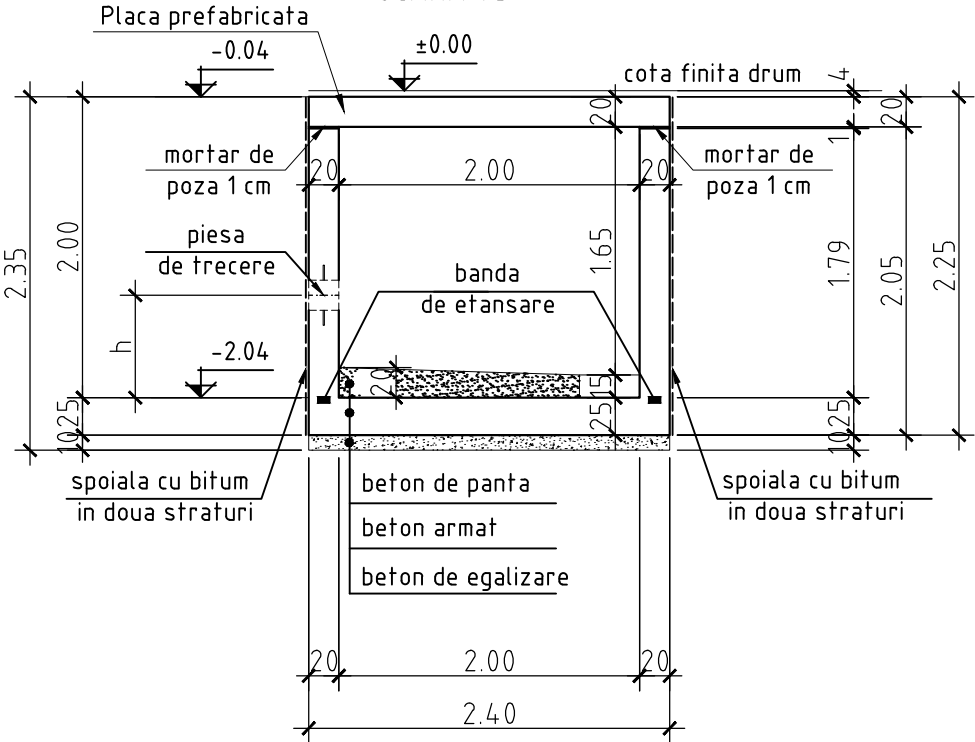

SECTIUNEA 2-2

SCARA 1:50

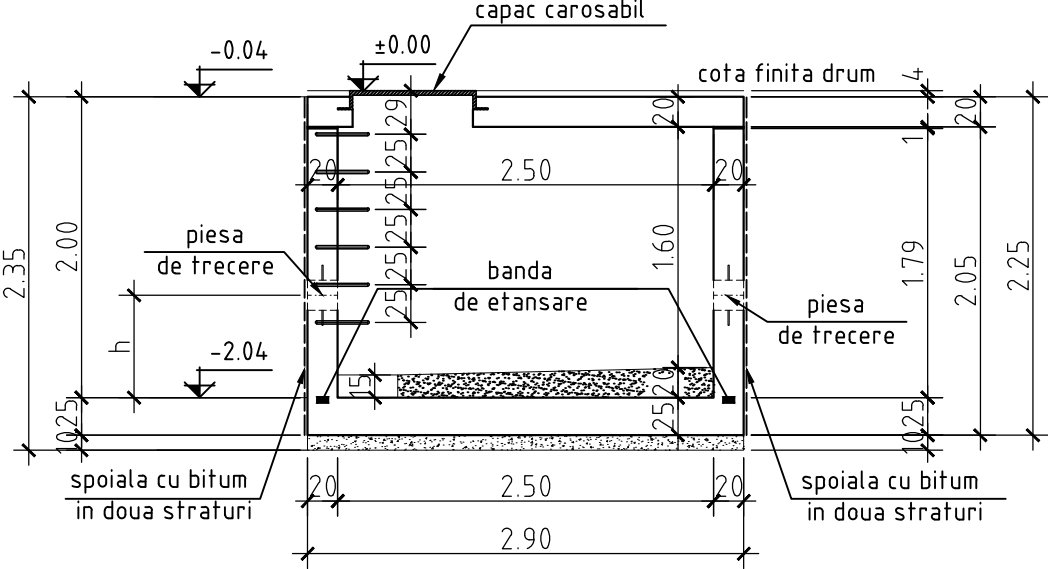

PLAN COFRAJ  
PLACA PREFABRICATA

SCARA 1:50

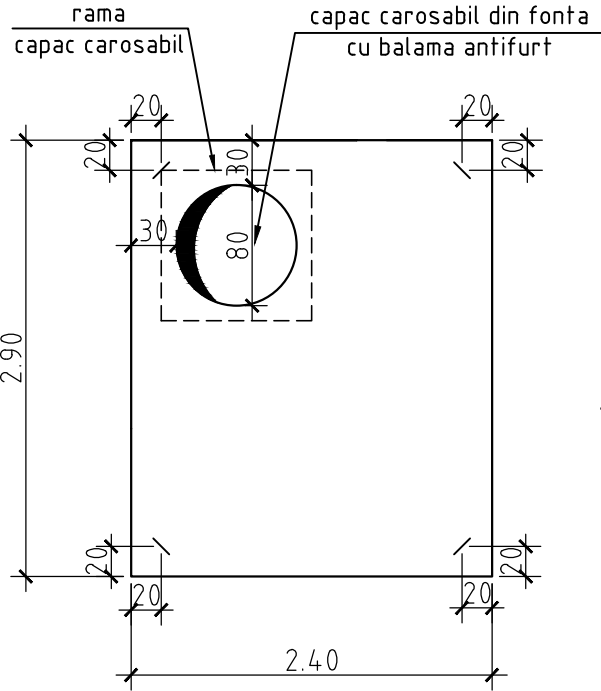

SECTIUNE ORIZONTALA

SCARA 1:50

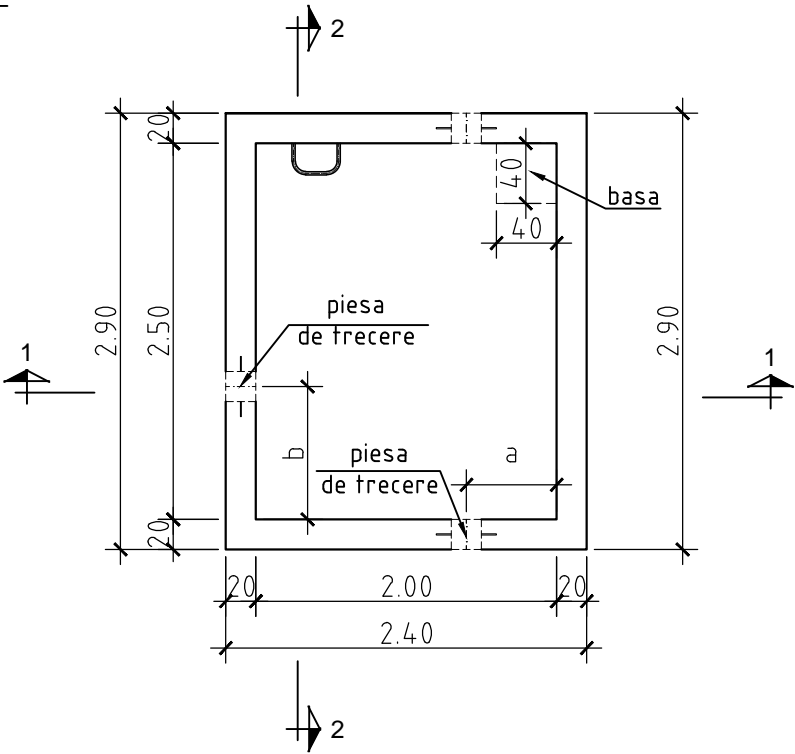

Rev	Nume	Ver	Aprb	Data	Descriere
-----	------	-----	------	------	-----------

Autoritatea contractanta: **S.C.AQUACARAS S.A. CARAS SEVERIN**



Adresa: P-lă Republicii, nr. 7, Resita  
Jud. Caras Severin  
Tel.: +40 255 212 458  
Fax.: +40 255 214 421  
E-mail: office@aquacaras.ro

Proiectant: **Consortiu S.C Eptisa Romania S.R.L. si Eptisa Servicios de Ingenieria S.L.**  
Sos. Dudesti-Pantelimon nr. 42, RAMS center, et. 5, corp A, sector 3, Bucuresti  
Tel: +40 21 301 14 70  
Fax: +40 21 301 14 80  
www.eptisa.com



Proiect: **MODERNIZAREA INFRASTRUCTURII DE APA SI APA UZATA IN JUDETUL CARAS SEVERIN - AGLOMERAREA RESITA**

Plansa: **Retele apa  
Camin tip 14-Plan Cofraj**

Desenat: Ing. B. Paraschiv Data: Feb. 2013  
Verificat: Ing. M. Serbanoiu Data: Feb. 2013  
Aprobat: Ing. D. Spiridon Data: Feb. 2013

Plansa nr. **CS-RE-PT/DA-A-R-14.1** Revizia **0**